

PART NUMBER	CURRENT RATING (A)	BODY COLOR	RATED VOLTAGE
0293020.MXJ	20	LIGHT BLUE	32V
0293030.MXJ	30	PINK	
0293040.MXJ	40	GREEN	
0293050.MXJ	50	RED	
0293060.MXJ	60	YELLOW	
0293070.MXJ	70	BROWN	
0293080.MXJ	80	BLACK	
0293100.MXJ	100	BLUE	

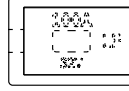
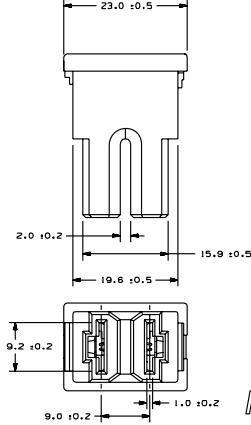
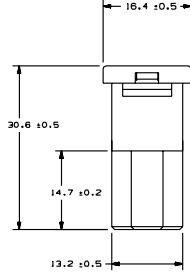

% OF RATED CURRENT	OPENING TIME	
	MIN	MAX
110%	14,400 SEC.	-
200%	5 SEC.	100 SEC.
350%	0.2 SEC.	7 SEC.
600%	0.04 SEC.	1 SEC.

METRIC

UNLESS OTHERWISE SPECIFIED, DIMENSIONS ARE IN MILLIMETERS. DIMENSIONS IN BRACKETS [ ] ARE INCHES. DIMENSIONS DO NOT INCLUDE PLATING, UNLESS OTHERWISE SPECIFIED. DIMENSIONS DO NOT INCLUDE PLATING.

CPK DENOTES CPK DIMENSIONS. MINIMUM CPK VALUE DENOTES A CHARACTERISTIC THAT PROVIDES AN INDICATION OF PROCESS VARIATION. CPK VALUE FOR MEASUREMENT AND TRACING TO BE OBTAINED IN ACCORDANCE WITH LITTELFUSE INSPECTION INSTRUCTIONS.

CP DENOTES CP DIMENSIONS. MINIMUM CP VALUE DENOTES A CHARACTERISTIC THAT PROVIDES AN INDICATION OF PROCESS VARIATION. CP VALUE FOR MEASUREMENT AND TRACING TO BE OBTAINED IN ACCORDANCE WITH LITTELFUSE INSPECTION INSTRUCTIONS. DIMENSIONS SHOWN ON DRAWINGS ARE INITIALLY LOGICATED TO ALLOW FOR MAXIMUM TOOL LIFE.

NO	COMPONENT NO	DESCRIPTION	QTY/M	U/M
BILL OF MATERIAL				
MATERIAL SPEC				

LTR	DATE	REVISION	CHK	APPD
A	06/14/09	00078289-RELEASE QMB		
B	03/26/10	0293020.MXJ, 0293030.MXJ, 0293040.MXJ, 0293050.MXJ, 0293060.MXJ, 0293070.MXJ, 0293080.MXJ, 0293100.MXJ QMB		

COPIES TO	MATL SPEC
1	9 18 FINISH
2	10 19
3	12 20
4	13 21 BFW QMB
5	14 22 CHK
6	15 23
7	16 24
8	17 53 APPD

DATE	SCALE	DATE	SCALE
06/14/09	7:1	06/14/09	7:1

DATE	SUPER DR	DATE	FINISH GOOD WT
06/14/09		06/14/09	

DATE	TOLERANCE UNLESS OTHERWISE SPECIFIED
06/14/09	ONE PLACE DEC +/- .4
06/14/09	TWO PLACE DEC +/- .05
06/14/09	THREE PLACE DEC +/- .010
06/14/09	ANGULAR +/- .1°

TITLE	SLOW BLOW FUSE AS TYPE
0293020.MXJ	

REVISION	DRWG. NO.	OUTLINE
B	029303000.MXJ	

